

OREGON PUBLIC LAND CORNER REPORT / RESTORATION REPORT
Tillamook County Surveyor's Office

BOOK 8 214

SECTION: 28, 29, 32 & 33	TOWNSHIP: 1 South	RANGE: 10 West
COUNTY: Tillamook		DATE: 12/10/2024
CORNER DESIGNATION: The Section Corner common to Sections 28, 29, 32 and 33 Township 1 South, Range 10 West; Willamette Meridian.		(Please check one)
		<input type="checkbox"/> Condition Report Only
		<input type="checkbox"/> Restoration
		<input checked="" type="checkbox"/> Rewitness
		<input type="checkbox"/> Unrecorded
		<input type="checkbox"/> Reset at surface
		<input type="checkbox"/> Referenced Out

Previous Rewitnesses, Restorations and Surveys, etc...
BLM Field Note Volume OR-R0337 Page 0271.00 (1890), S3 page 196 (1898), Rewitness bk. 5 pg. 270 (1966), Rewitness Card #326 (1977) Map B-786 (1978), Map B-3361 (2009).

History, condition, and sources
In 1890 (BLM Field Note Volume: OR-R0337 Page 0271.00) Albert P. Wilson set a post 4' long 4" square and 2' deep for the Section Corner with scribing and notches on all sides and established four bearing trees. In 1966 (Rewitness bk. 5 pg. 270) the Tillamook County Surveyors Office found a 1 1/2" iron pipe 10" high. Based on the rewitness book notes it appears to be in original position based on existing GLO bearings trees that were found. There is no record of the setting of the 1 1/2" iron pipe only records of it being found. In 1977 (Rewitness card #326) the Tillamook County Surveyors Office replaced the 1 1/2" iron pipe with a 2" iron pipe with a 3" Tillamook County brass cap in 10" tile and cement stamped "T1S R10W S29 S28 S32 S33 RS 287 1977" as shown hereon; from which 3 new bearing trees were established. In 2024 the Tillamook County Surveyors office found the Section corner to be in good condition and stamped as shown hereon. The found accessories are listed below.

- Found:** (Rewitness Card #326 1977) 4"x4" white cedar post North 1.1' **now** found on ground next to monument.
- Found:** (Rewitness Card #326 1977) steel post S.E. **now** West 2.1' with metal location tag.
- Found:** (Rewitness Card #326 1977) 4" dia. Hemlock N 4° E 16.42' (Map B-3361 2009) 12" dia. Hemlock N 4° E 16.42' healed scar **now** 14" dia. N 4° E 16.2' no visible scar.
- Found:** (Rewitness Card #326 1977) 5" dia. Hemlock S 89° W 27.31' (Map B-3361 2009) 12" dia. Hemlock with healed face **now** 12" dia. hemlock.
- Found:** (Rewitness Card #326 1977) 3" dia. Hemlock N 64° W 29.42' with chopped X (Map B-3361 2009) 8" dia. Hemlock with visible X N 64° W 29.42' **now** 8" dia. dead snag no X visible or scar.
- Found:** (Map B-3361 2009) 11" dia. hemlock scribed "T1S R10W S33 BT" with 3/4" brass washer and nail stamped 'LS 2507" S 80° E 3.95' **now** 13" dia. 3.9' with healed scar.

New accessories set:
The monument was tied conventionally using double tied GPS control in Oregon North Zone NAD 83/91 grid coordinates in US Survey feet. Coordinates provided hereon are given in WGS 84 Latitude and Longitude.

Latitude: 45°26'58.61599"
Longitude: -123°55'39.66517"

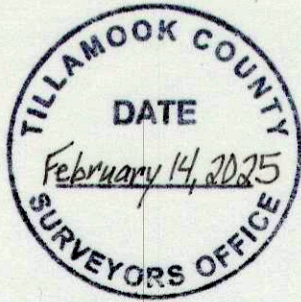

Pictures of Found Monuments:



Location: ± 600' East of logging road #250

Tillamook County Surveyor office: 1510 3rd Street Suite C, Tillamook, OR. 97141

Party Chief: Travis Porter, Tillamook County Surveyors Office

Witnesses: Michael Rice P.L.S. 86926, Tillamook County Surveyor
Kael Poklikuha, Tillamook County Survey Technician

Notes: Digital images taken of monument and accessories.

SURVEYOR'S SEAL

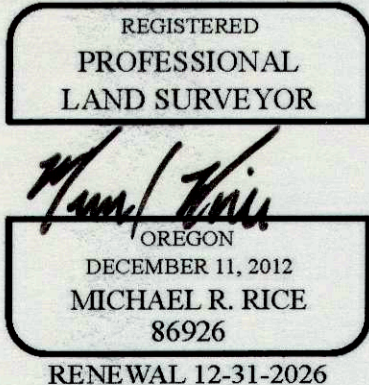

BOOK 8 214